

## EA Series Ultraviolet Sanitizer



### SPECIFICATIONS

The Ultraviolet Sanitizer Unit shall be a Delta Ultraviolet Corporation Model EA-\_\_\_\_\_, rated at \_\_\_\_\_ Volts, 50/60 Hz. The unit shall be equipped with a plug-in ballast assembly and 60 inch (152.4 cm) long power cord. The unit shall be housed in a 3 inch (7.62 cm) Stainless Steel housing, complete with unions at each end to allow for total disassembly for cleaning and rotation of inlet and outlet unions to facilitate 360° piping installation. PVC Inlet/Outlet unions shall be \_\_\_\_\_ (inch/cm) socket size. The UV Lamp shall be rated at 9000 hours of continuous use and shall be fully replaceable without requiring special tools. The UV Lamp shall be rated at no less than 30,000  $\mu\text{watts}/\text{sec}/\text{cm}^2$  (Class A drinking water requirement) at EOL and shall bear the EPA Registration number on the unit, cartons, and printed literature. The UV unit shall be warranted for one [1] year and shall be accompanied by a printed factory Limited Warranty, Owner's Installation and Operation manual.



| Model | Part Number | Amps  | Voltage      | I/O Size |
|-------|-------------|-------|--------------|----------|
| EA-9  | 35-08309    | 0.070 | 120V/50/60Hz | 2 inch   |
| EA-9  | 35-08311    | 0.070 | 120V/50/60Hz | 63mm     |
| EA-9  | 35-08312    | 0.035 | 240V/50/60Hz | 2 inch   |
| EA-9  | 35-08313    | 0.035 | 240V/50/60Hz | 63mm     |
| EA-18 | 35-08318    | 0.015 | 120V/50/60Hz | 2 inch   |
| EA-18 | 35-08319    | 0.015 | 120V/50/60Hz | 63mm     |
| EA-18 | 35-08321    | 0.075 | 240V/50/60Hz | 2 inch   |
| EA-18 | 35-08322    | 0.075 | 240V/50/60Hz | 63mm     |

| Model | Part Number | Amps  | Voltage      | I/O Size |
|-------|-------------|-------|--------------|----------|
| EA-26 | 35-08326    | 0.216 | 120V/50/60Hz | 2 inch   |
| EA-26 | 35-08327    | 0.216 | 120V/50/60Hz | 63mm     |
| EA-26 | 35-08328    | 0.108 | 240V/50/60Hz | 2 inch   |
| EA-26 | 35-08329    | 0.108 | 240V/50/60Hz | 63mm     |
| EA-40 | 35-08341    | 0.333 | 120V/50/60Hz | 2 inch   |
| EA-40 | 35-08342    | 0.333 | 120V/50/60Hz | 63mm     |
| EA-40 | 35-08343    | 0.166 | 240V/50/60Hz | 2 inch   |
| EA-40 | 35-08344    | 0.166 | 240V/50/60Hz | 63mm     |

| Model | Cord Length    | Bulb Output (EOL)                           |
|-------|----------------|---|
| EA-9  | 60" (152.4 cm) | 30,000 $\mu\text{W}/\text{sec}/\text{cm}^2$ |
| EA-18 | 60" (152.4 cm) | 30,000 $\mu\text{W}/\text{sec}/\text{cm}^2$ |

| Model | Cord Length    | Bulb Output (EOL)                           |
|-------|----------------|---|
| EA-26 | 60" (152.4 cm) | 30,000 $\mu\text{W}/\text{sec}/\text{cm}^2$ |
| EA-40 | 60" (152.4 cm) | 30,000 $\mu\text{W}/\text{sec}/\text{cm}^2$ |

### POOL FLOW CHART

| Delta UV EA Model | Maximum Flow Rate (GPM) | Maximum Flow Rate (LPM) | Minimum UV Microwatts $\text{sec}/\text{cm}^2$ | Max Pool Volume 12 Hr. Turnover (Gallons) | Max Pool Volume 12 Hr. Turnover (Liters) | Max Pool Volume 8 Hr. Turnover (Gallons) | Max Pool Volume 8 Hr. Turnover (Liters) |
|-------------------|-------------------------|-------------------------|--|---|--|--|---|
| EA-9              | 3                       | 23                      | 30200  | 4320                                      | 16353                                    | 2880                                     | 10902                                   |
| EA-18             | 6                       | 34                      | 30790  | 6480                                      | 24529                                    | 4320                                     | 16353                                   |
| EA-26             | 9                       | 57                      | 30200  | 10800                                     | 40882                                    | 7200                                     | 27255                                   |
| EA-40             | 14                      | 87                      | 30080  | 16560                                     | 62686                                    | 11040                                    | 41791                                   |

### POND FLOW CHART

| Delta UV EA Model | Maximum Flow Rate (GPM) | Maximum Flow Rate (LPM) | Minimum UV Microwatts $\text{sec}/\text{cm}^2$ | Max Volume 2 Hr. Turnover (Gallons) | Max Volume 2 Hr. Turnover (Liters) | Max Volume 3 Hr. Turnover (Gallons) | Max Volume 3 Hr. Turnover (Liters) | Max Volume 4 Hr. Turnover (Gallons) | Max Volume 4 Hr. Turnover (Liters) |
|-------------------|-------------------------|-------------------------|--|-------------------------------------|------------------------------------|-------------------------------------|------------------------------------|-------------------------------------|------------------------------------|
| EA-9              | 3                       | 23                      | 30200  | 720                                 | 2725                               | 1080                                | 4088                               | 1440                                | 5451                               |
| EA-18             | 6                       | 34                      | 30790  | 1080                                | 4088                               | 4320                                | 16353                              | 2160                                | 8176                               |
| EA-26             | 9                       | 57                      | 30200  | 1800                                | 6814                               | 2700                                | 10221                              | 3600                                | 13627                              |
| EA-40             | 14                      | 87                      | 30080  | 2760                                | 10448                              | 4140                                | 15672                              | 5520                                | 20895                              |

### Physical Dimensions

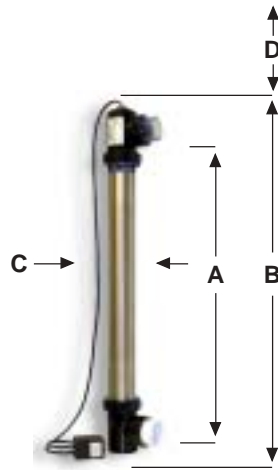

| Model | Dim. A                 | Dim. B                 | Dim. C           | Dim. D                 | Empty Wt.          | Operating Wt.       | Shipping Wt.       | Carton Size                                 |
|-------|------------------------|------------------------|------------------|------------------------|--------------------|---------------------|--------------------|---|
| EA-9  | 10.875 in.<br>276.2 mm | 15.875 in.<br>403.2 mm | 3 in.<br>76.2 mm | 14.5 in.<br>386.3 mm   | 5.5 lbs<br>2.49 kg | 9 lbs<br>4.08 kg    | 6.5 lbs<br>2.95 kg | 23-1/4"x6"x8-3/8"<br>590.5 x 152.4 x 212.9  |
| EA-18 | 13.5 in.<br>342.9 mm   | 18.5 in.<br>469.9 mm   | 3 in.<br>76.2 mm | 17.125 in.<br>434.9 mm | 6 lbs<br>2.72 kg   | 10 lbs<br>4.54 kg   | 7 lbs<br>3.18 kg   | 25-7/8"x6"x8-3/8"<br>682.6 x 152.4 x 212.9  |
| EA-26 | 17.75 in.<br>450.8 mm  | 22.75 in.<br>577.8 mm  | 3 in.<br>76.2 mm | 21.375 in.<br>542.9 mm | 6.5 lbs<br>2.95 kg | 11.5 lbs<br>5.22 kg | 7.5 lbs<br>3 kg    | 30-1/8"x6"x8-3/8"<br>765.1 x 152.4 x 212.9  |
| EA-40 | 32.125 in.<br>815.9 mm | 37.125 in.<br>942.9 mm | 3 in.<br>76.2 mm | 35.75 in.<br>908.1 mm  | 8.5 lb<br>3.86 kg  | 17 lbs<br>7.71 kg   | 10 lbs<br>4.54 kg  | 44-1/2"x6"x8-3/8"<br>1130.3 x 152.4 x 212.9 |

All weights and dimensions nominal.

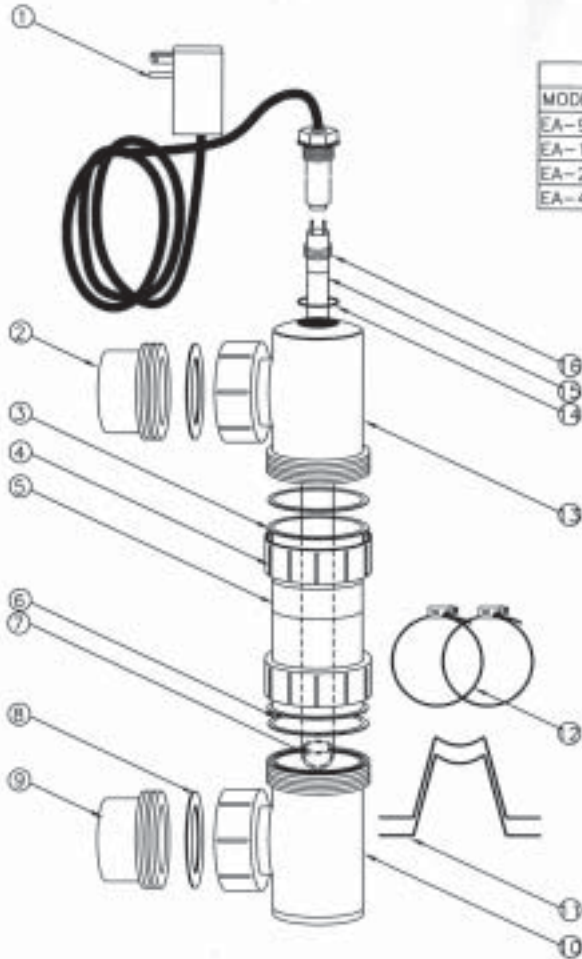

| PART NUMBER MATRIX |              |              |          |          |          |
|--------------------|--------------|--------------|----------|----------|----------|
| MODEL              | ITEM #1-120V | ITEM #1-240V | ITEM #3  | ITEM #13 | ITEM #15 |
| EA-9               | 70-10131     | 70-10231     | 78-07342 | 58-50210 | 70-18309 |
| EA-18              | 70-10132     | 70-10232     | 78-07344 | 58-50217 | 70-18316 |
| EA-26              | 70-10132     | 70-10232     | 78-07346 | 58-50227 | 70-18326 |
| EA-40              | 70-10132     | 70-10232     | 78-07348 | 58-50241 | 70-18340 |

| TAIL PIECE MATRIX |           |          |
|-------------------|-----------|----------|
| SIZE              | ITEM #2   | ITEM #9  |
| 2" SKT            | 86-02352C | 86-02352 |
| 63 mm             | 86-02403  | 86-02353 |

NOTE: OPTIONAL SIZE TAIL PIECES ARE AVAILABLE - CONTACT YOUR SUPPLIER OR DELTA UV FOR INFORMATION

|      |                                |     |            |
|------|--------------------------------|-----|------------|
| 15   | BULB O-RING                    | 2   | 44-02221   |
| 15   | HO UV BULB                     | 1   | SEE MATRIX |
| 14   | ORING-024-BLACK                | 1   | 44-02216   |
| 13   | QUARTZ TUBE TEE ASSEMBLY       | 1   | SEE MATRIX |
| 12   | CLAMP-3" STAINLESS STEEL       | 2   | 40-08004   |
| 11   | STAND-STAINLESS STEEL          | 2   | B2-02019   |
| 10   | QUARTZ END HOLDER TEE ASSEMBLY | 1   | 86-02035   |
| 9    | UNION TAIL PIECE-WHITE         | 1   | SEE MATRIX |
| 8    | FLAT O-RING GASKET-2"          | 2   | 44-02335   |
| 7    | BULB CUSHION                   | 1   | 44-02019   |
| 6    | FLAT O-RING GASKET-3"          | 2   | 44-02340   |
| 5    | TANK ID LABEL-SELF ADHESIVE    | 1   | 48-02206   |
| 4    | UNION NUT 3"-BLACK             | 1   | 86-02370   |
| 3    | UV BODY-3" STAINLESS STEEL     | 1   | SEE MATRIX |
| 2    | UNION TAIL PIECE-CLEAR         | 1   | SEE MATRIX |
| 1    | ELECTRONIC BALLAST ASSEMBY     | 1   | SEE MATRIX |
| ITEM | DESCRIPTION                    | QTY | PART #     |